



ATD-16801

Professional Air Dryer Gun Stand



Manufactured in China to ATD Tools, Inc. Specifications

Assembly Instructions:

- 1) Assemble feet to base
- 2) Mount the vertical tube, be sure to place the ring with the locking screw downwards
- 3) Mount the horizontal bar
- 4) Assemble both air hoses to the five port air inlet
- 5) Place the two gun supports on the horizontal bar

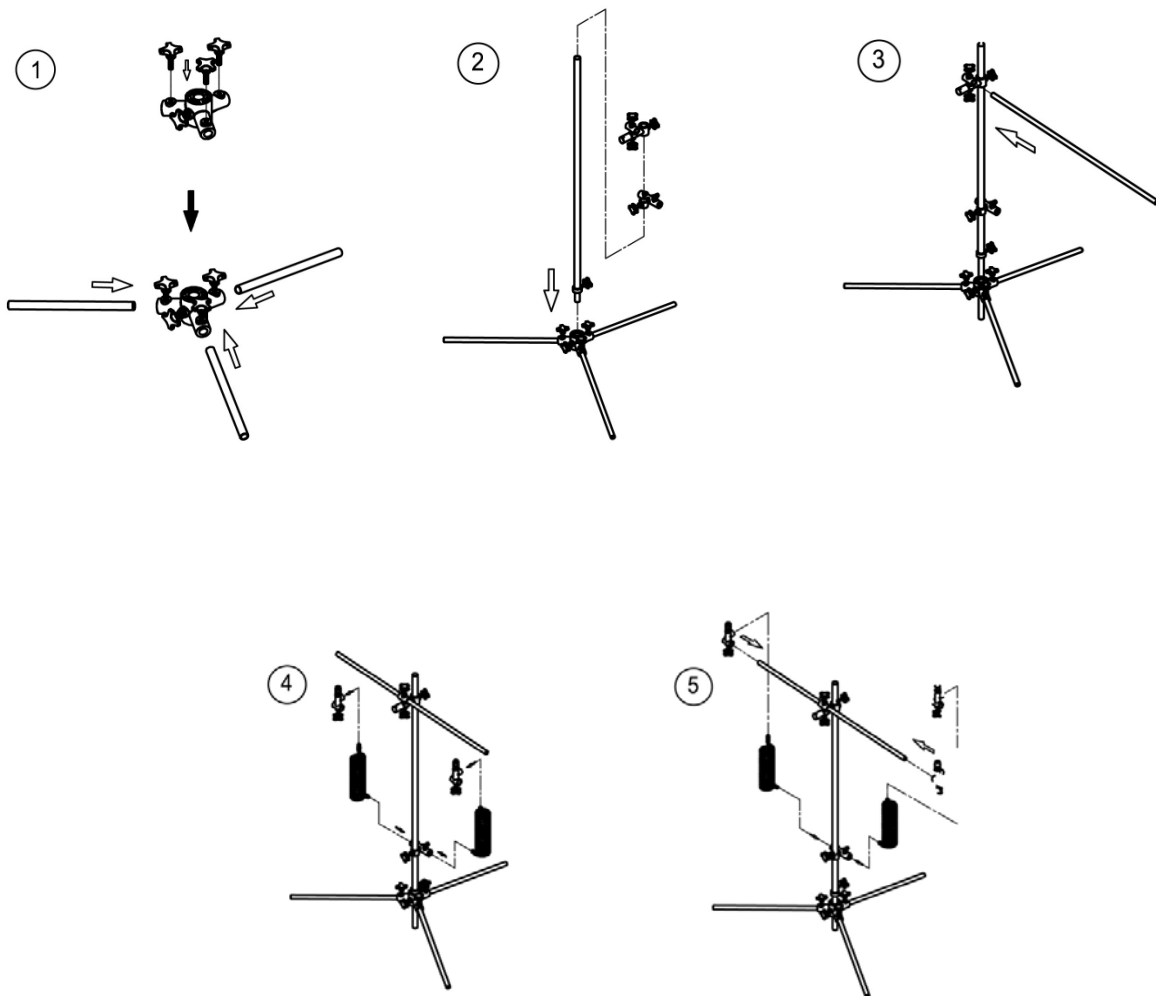

ATD-16801

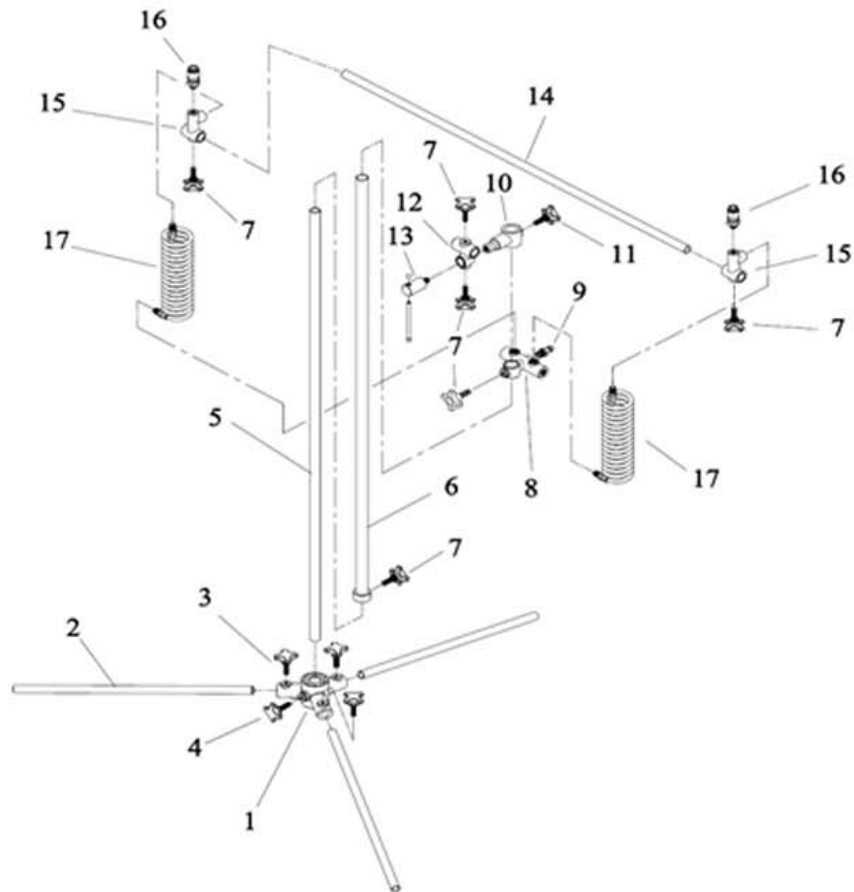

ITEM#	ORDERING PART#	PART DESCRIPTION
1	PRT16801-01	END STAND
2	PRT16801-02	STEEL TUBE
3	PRT16801-03	HANDLE SCREW
4	PRT16801-04	HANDLE SCREW (M8*35)
5	PRT16801-05	VERTICAL TUBE
6	PRT16801-06	MOVABLE TUBE
7	PRT16801-07	HANDLE SCREW
8	PRT16801-08	AIR INLET
9	PRT16801-09	PLUG
10	PRT16801-10	SWIVEL BODY
11	PRT16801-11	HANDLE SCREW
12	PRT16801-12	ROTARY SEAT
13	PRT16801-13	LEVEL SCREW
14	PRT16801-14	ARM
15	PRT16801-15	GUN BRACKET
16	PRT16801-16	COUPLER
17	PRT16801-17	8*12*5M HOSE